

SECTION II

TM 10-3930-242-24P

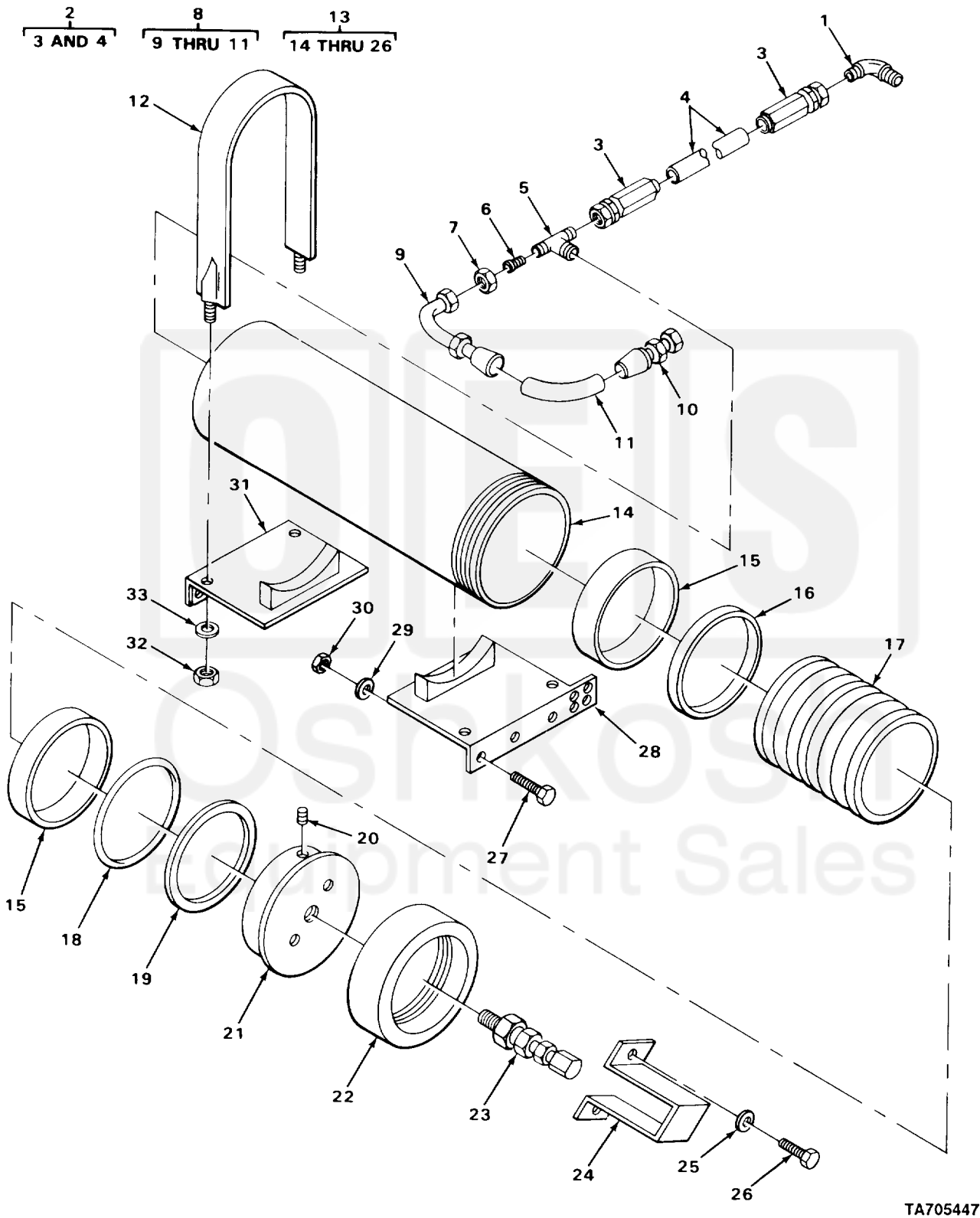

FIGURE 121. HYDRAULIC BRAKE ACCUMULATOR AND HOSES.

Current part is item (13) on diagram. Available at www.oshkosheshequipment.com

ITEM NO	SMR CODE	CAGEC	PART NUMBER	DESCRIPTION AND USABLE ON CODES (UOC)	QTY
GROUP 1204 HYDRAULIC BRAKE SYSTEM					
FIG. 121 HYDRAULIC BRAKE ACCUMULATOR AND HOSES					
1	XDOZZ	01276	94-2039-12-12	ELBOW,TUBE TO HOSE	1
2	AOOOO	96906	94A276603-12-34	HOSE ASSEMBLY ACCUMULATOR TEE TO COCKPIT BULKHEAD	1
3	PFOZZ	81349	M52525/1-12-12	.ADAPTER,STRAIGHT,TU	2
4	MOOZZ	19207	6399899-29	.HOSE,RUBBER MAKE FROM HOSE P/N 5F6914	1
5	PAOZZ	98441	12S50XS	TEE,TUBE TO BOSS ACCUMULATOR TUBES	1
6	PFOZZ	96906	MS515343B12-4	REDUCER BODY,TUBE ACCUMULATOR UOC:CQK,U72	1
6	PAOZZ	03677	LT1-887	REDUCER BODY,TUBE HYDRAULIC BRAKE ACCUMULATOR UOC:CMQ,U73,U74	1
7	PAOZZ	01276	94-1290-12	NUT,TUBE COUPLING REDUCER TO TUBE MTG UOC:CQK,U72	1
7	PAOZZ	88044	AN818-12	NUT,TUBE COUPLING RESTRICTOR TO TEE MTG UOC:CMQ,U73,U74	1
8	AOOOO	01276	94A276620-4-13-1-2	HOSE ASSEMBLY ACCUMULATOR TO BRAKE SIGNAL SWITCH UOC:CQK,U72	1
8	AOOOO	00624	A276620-4-12-1-2	HOSE ASSEMBLY ACCUMULATOR TO BRAKE SIGNAL VALVE UOC:CMQ,CMQ,U73,U74	1
9	PAOZZ	01276	94-190287-4	.ELBOW,TUBE TO HOSE	1
10	PAOZZ	01276	94-4721-4-4	.ADAPTER,STRAIGHT,TU	1
11	MOOZZ	19207	0175127-10	.HOSE,RUBBER MAKE FROM HOSE P/N M52471/5-4 UOC:CQK,U72	1
11	MOOZZ	19207	9304513-10	.HOSE,RUBBER MAKE FROM HOSE P/N 2766-4 UOC:CMQ,CMQ,U73,U74	1
12	XBFZZ	04285	PG9086	STRAPP,METAL ACCUMULATOR MTG UOC:CQK,U72	2
12	XBFZZ	03677	LT1-820	STRAP,METAL ACCUMULATOR MTG UOC:CMQ,CMQ,U73,U74	2
13	PAFZZ	14108	810-1	ACCUMULATOR,HYDRAUL ASSEMBLY	1
14	XAFZZ	14108	503-147	.BODY	1
15	PAFZZ	14108	7-143	.RING,ACCUMULATOR ACCUMULATOR UOC:CQK,U72	2
15	PAFZZ	03677	LT1-298	.RING,PISTON ACCUMULATOR UOC:CMQ,CMQ,U73,U74	2
16	PAFZZ	14108	2160240	.SEAL,PLAIN PISTON,ACCUMULATOR UOC:CQK,U72	1
16	PAFZZ	03677	LT1-299	.SEAL,PLAIN ACCUMULATOR UOC:CMQ,CMQ,U73,U74	1
17	XAFZZ	14108	8-146	.PISTON	1

Current part is item (13) on diagram. Available at www.oshkosheshequipment.com